

Guess? Who?

STAR WARS™

EDITION

FOR 2 PLAYERS
AGES 6+

CONTENTS

- 2 Gameboard trays
- 24 Mystery Star Wars character cards
- 48 Star Wars facecards and frames
- 2 Score keepers

In a galaxy far, far away, there was a disturbance in the force. It is up to you to help a friend, or defeat the dark side. Use the force to find out who is causing the disturbance. Keep the questions coming to uncover the mystery identity of your friend or enemy.

ASSEMBLY

ADULT ASSEMBLY REQUIRED

THE FIRST TIME YOU PLAY

- 1.** Carefully twist the 48 frames and the 2 two-piece score keepers off of the plastic runners. Discard the waste.
- 2.** Gently detach the 48 character cards and the 24 Mystery character cards from the sheet. Discard the waste.
- 3.** Slide each character card into a frame, as shown in Figure 1.

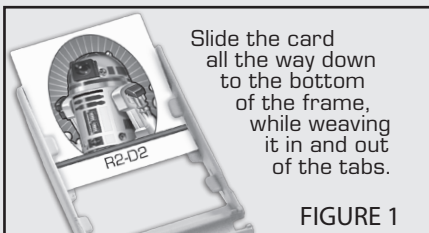

- 4.** Attach the 48 loaded frames to the gameboards. Attach the blue color frames to the blue gameboard and the black frames to the black gameboard. See Figure 2.

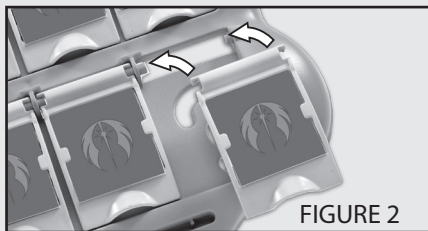
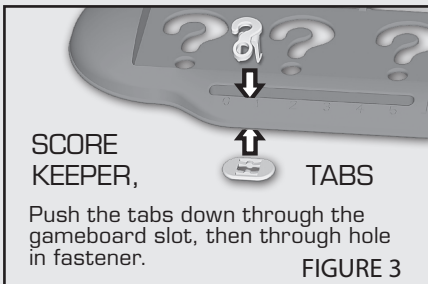

FIGURE 2

It doesn't matter which gameboard positions the frames occupy. After attaching each frame, flip it up and down to make sure that it fits properly.

- 5.** Attach a score keeper to each gameboard as shown in Figure 3. Use the score keepers for Championship Play only.



OBJECT

Guess your opponent's Star Wars mystery character before your opponent guesses yours.

GAME SETUP

SET UP YOUR GAMEBOARD

Each player chooses a gameboard. Place your gameboard on a flat surface. Flip all of your frames upright by tipping your gameboard away from you; then set your gameboard flat again. Your opponent does the same.

DRAW YOUR MYSTERY CARD

Shuffle your Mystery cards. Choose two cards at random, choose which one you want to play, and fit it into your Mystery card slot so that your Mystery character faces you. See Figure 4.



Return the card you didn't choose facedown to the deck. Your opponent does the same. Then place all unused Mystery cards out of play. Sit facing your opponent, so that he or she can't see the Mystery character on your card!

GAMEPLAY

The youngest player goes first. On your turn, you may either ask a question or guess who your opponent's character is. But don't use your turn to guess the mystery character until you're ready! If your guess is wrong, you lose the game!

THE STAR WARS CHARACTERS ON YOUR GAMEBOARD

Notice the differences among the 24 characters on your gameboard. There are different kinds of Star Wars characters: some are Jedi, some have turned to the dark side, some are human, some are from alien planets, and others are droids. Look at the table on page 3 to learn about your characters. Rules for asking questions and guessing the Mystery Character are explained below.

ASKING QUESTIONS

1. Until you're ready to guess who the mystery character is, ask your opponent one question per turn. Each question must have either a "yes" or "no" answer. For example, you may ask: "Is your mystery character human?" Your opponent must then answer either "yes" or "no."

2. After your opponent answers, you may be able to eliminate one or more of the mystery characters on the gameboard. For example, if your opponent answers "Yes the mystery character is human", flip down all of the mystery characters that are alien, or droids. This leaves only the human characters.

3. After you ask a question (and flip down any mystery characters you can), your turn is over.

NAME	GENDER	SPECIES	SPECIAL ROLES	LIGHT/DARK SIDE	AFFILIATION/ GROUP
Aayla Secura	Female	Twilek	Jedi	Light Side	Republic
Ahsoka Tano	Female	Togruta	Jedi	Light Side	Republic
Anakin Skywalker	Male	Human	Jedi	Light Side	Republic
Asajj Ventress	Female	Rattataki	Sith	Dark Side	Separatist
Boba Fett	Male	Human	Bounty Hunter	Dark Side	Unknown
C-3PO	Male	Droid	Droid	Light Side	Republic or Rebel Alliance
Captain Rex	Male	Human	Clone Trooper	Light Side	Republic
Chewbacca	Male	Wookiee	Rebel Pilot	Light Side	Republic or Rebel Alliance
Count Dooku	Male	Human	Sith	Dark Side	Separatist
Darth Maul	Male	Zabrak	Sith	Dark Side	Separatist
Darth Vader	Male	Human	Sith	Dark Side	Empire
Emperor Palpatine	Male	Human	Sith	Dark Side	Empire
General Grievous	Male	Kaleesh/ Droid	Separatist Leader	Dark Side	Separatist
Han Solo	Male	Human	Rebel Pilot	Light Side	Rebel Alliance
Jabba the Hutt	Male	Hutt	Criminal	Dark Side	Unknown
Kit Fisto	Male	Nautolan	Jedi	Light Side	Republic
Luke Skywalker	Male	Human	Jedi	Light Side	Rebel Alliance
Mace Windu	Male	Human	Jedi	Light Side	Republic
Obi-Wan Kenobi	Male	Human	Jedi	Light Side	Republic
Padmé Amidala	Female	Human	Republic Leader	Light Side	Republic
Princess Leia	Female	Human	Rebel Leader	Light Side	Rebel Alliance
R2-D2	Male	Droid	Droid	Light Side	Republic or Rebel Alliance
Wicket W. Warrick	Male	Ewok	Warrior	Light Side	Rebel Alliance
Yoda	Male	Unknown	Jedi	Light Side	Republic

GUESSING THE STAR WARS MYSTERY CHARACTER

When you're ready to guess who the mystery character is, make your guess on your turn instead of asking a question.

To guess the mystery character, say (for example), "The mystery character is Luke Skywalker." Your opponent must then tell you whether or not your guess is correct. If your guess is right, you win the game! If it's wrong, you lose!

HOW TO WIN

Players alternate turns asking questions, until one player makes a guess. If you guess correctly — or your opponent guesses incorrectly — you win the game!

CHALLENGE GAME

For an extra challenge, both players draw two Mystery cards, and place them side-by-side in their Mystery card slots. Your object is to guess who both of your opponent's Mystery Characters are!

You must say "both" or "either" when asking questions about the Mystery Characters. For example, you may ask, "Do both of your Star Wars characters have hair all over their bodies?" or, "Do either of your Star Wars characters have a cloak on?" Be careful when eliminating gameboard characters — and remember which questions you've asked!

For example, you ask, "Are either of your mystery characters droids?" Your opponent answers "yes." You cannot flip down any characters because although one mystery character definitely is a droid, the other one may not be!

To guess the mystery characters correctly, you must guess both of them on the same turn.

CHAMPIONSHIP PLAY

If you wish to play a series of games, slide the score keeper up one point for every game you win. The first player to win five games is the Champion!



Not suitable for children under 3 years because of small parts - choking hazard.

© 2008 Lucasfilm Ltd. & TM. A Theora Concept.

The HASBRO and MB names and logos and GUESS WHO are TM, ® & © 2008 Hasbro, Pawtucket, RI 02862. All Rights Reserved. TM & ® denote U.S. Trademarks. 1010489800

We will be happy to hear your questions or comments about this game. US consumers please write to: Hasbro Games, Consumer Affairs Dept., P.O. Box 200 Pawtucket, RI 02862. Tel.: 888-836-7025 (toll free). Canadian consumers please write to: Hasbro Canada Corporation, 2350 de la Province, Longueuil QC Canada J4G 1G2. European consumers please write to: Hasbro UK Ltd., Hasbro Consumer Affairs, P.O. BOX 43, Caswell Way, Newport, Wales, NP194YD, or telephone our Helpline on 00 800 2242 7276.

MBTM
GAMES



hasbrogames.com



PROOF OF PURCHASE

MBTM
GAMES
04898

